

# **EXHIBIT B**

**2015 FLORIDA HIGH SCHOOL ATHLETIC ASSOCIATION  
FOOTBALL FINALS**

**PARTICIPANT MANUAL**



**ORLANDO CITRUS BOWL  
DECEMBER 4<sup>th</sup> – 5<sup>th</sup>  
AND  
DECEMBER 11<sup>th</sup> – 12<sup>th</sup>**

**LOCAL ORGANIZING COMMITTEE  
Central Florida Sports Commission  
City of Orlando  
Boone High School  
Orange County Public Schools  
Central Florida Officials Association**

<b>TABLE OF CONTENTS</b>
--------------------------

Cover Page.....	1
Table of Contents.....	2
I. General Information.....	3
1. Local Organizing Committee Personnel.....	3
2. Schedule of Events.....	3
3. Ticket Information.....	4
4. Seating.....	4
5. Parking.....	5
6. Admission to Games.....	6
7. Admission, Access, and Conduct Standards.....	9
II. Facility and Game Operations.....	10
1. Rules and Officials.....	10
2. Playing Field.....	11
3. Equipment and Facilities.....	11
4. Gatorade Coolers, Towels, and Squeeze Bottles.....	11
5. Locker Rooms.....	11
6. Coaches Viewing Area.....	12
7. Premises.....	12
8. Sidelines.....	13
III. Security.....	14
IV. Medical.....	14
1. Emergency Medical Service.....	14
2. Athletic Trainers.....	15
3. Other Medical.....	15
V. Inclement Weather.....	15
VI. Awards and Pre-Game Introductions.....	15
1. Pre-Game Warm-ups and Meetings.....	15
2. National Anthem.....	16
3. Introduction of Starters.....	16
4. Coin Toss.....	16
5. Post-Game Interviews.....	16
6. Post-Game Awards Ceremony.....	17
7. Timeouts and Breaks Between Quarters.....	17
VII. Stadium Clearing Plan.....	18
1. Transition.....	18
2. Locker Rooms.....	18
3. Other Factors.....	18
VIII. Housing.....	19
IX. Game Day Schedules.....	20
X. Appendix.....	28
1. Information, Credentials, and Supplies Request Sheet.....	28
2. Awards Presentation Lineup Sheet.....	32
3. Game Viewing Form.....	34
4. Directions to Orlando.....	36
5. Parking Map.....	37
6. Facility Overview Map.....	38
7. Press Box Map.....	39
8. Backhouse Facility Map.....	40

<b>I. GENERAL INFORMATION</b>
-------------------------------

**1. Local Organizing Committee Personnel**

Name	Area	Phone	Email
Beasley, Frank	FHSAA Event Director	352-372-9551 ext.250	<a href="mailto:fbeasley@fhsaa.org">fbeasley@fhsaa.org</a>
Buchalter, Bill	Media Representative	N/A	<a href="mailto:bbuchalter@cfl.rr.com">bbuchalter@cfl.rr.com</a>
Fazzio, Mitch	Officials Coordinator from CFOA	407-756-8323	<a href="mailto:mfazzio@fazziogroup.net">mfazzio@fazziogroup.net</a>
Larsen, Matt	Assistant Stadium Manager	407-440-5704	<a href="mailto:Matthew.larsen@cityoforlando.net">Matthew.larsen@cityoforlando.net</a>
Lastik, Jennifer	Event Chairman	407-648-1610	<a href="mailto:jlastik@centralfloridasports.org">jlastik@centralfloridasports.org</a>
Masias, Megan	Event Manager	407-515-6550	<a href="mailto:mmasias@centralfloridasports.org">mmasias@centralfloridasports.org</a>
Polansky, Seth	Membership/Web Specialist	352- 372-9551 ext. 400	<a href="mailto:spolansky@fhsaa.org">spolansky@fhsaa.org</a>
Sobers, Corey	Public Relations Specialist	352- 372-9551 ext. 350	<a href="mailto:csobers@fhsaa.org">csobers@fhsaa.org</a>
Sparks, John	Stadium Operations	407-440-5706	<a href="mailto:john.sparks@cityoforlando.net">john.sparks@cityoforlando.net</a>
Wilson, Wes	Media/ Volunteer Coordinator	407-648-4900 ext. 110	<a href="mailto:wwilson@centralfloridasports.org">wwilson@centralfloridasports.org</a>

**2. Schedule of Events**

Friday, December 4, 2015

2A Championship	1:07 PM
1A Championship	7:07 PM

Saturday, December 5, 2015

3A Championship	1:07 PM
4A Championship	7:07 PM

Friday, December 11, 2015

5A Championship	1:07 PM
7A Championship	7:07 PM

Saturday, December 12, 2015

6A Championship	1:07 PM
8A Championship	7:07 PM

### 3. Ticket Information:

Admission to the FHSAA Football Finals shall be by ticket, credential, or approved passes. The FHSAA will print all event credentials.

#### **A. Tickets:**

Advance tickets for the FHSAA Football Finals will be available for purchase through Ticketmaster or at the Amway Center Box Office. Reserved tickets will be \$17.00 per ticket and general admission will be \$12.00 per ticket. Day of game sales will be sold at the ticket booth located at Gate A. Sales will begin no later than 1 ½ hours prior to kick off of the first game each day and will remain open until the completion of the final game of the day. All non-credential-bearing spectators, except babies in arms, will be required to have a ticket.

#### **B. FHSAA Passes:**

Individuals holding FHSAA State Series Passes or FHSAA Lifetime Passes shall be admitted for the general admission seating areas without charge upon presentation of the pass and proper identification (ex. driver's license) and by signing the appropriate log. This pass admits the pass holder only. All guests must purchase an advance ticket through: Ticketmaster, at the Amway Center Box Office or at the Orlando Citrus Bowl Gate A ticket window. Holders of a current FHSAA State Series Pass must be age 18 or older, and may only enter the stadium through the East Breezeway, located between Gate C and Gate D. No other passes shall be honored for complimentary admission except the FHSAA Lifetime Membership Passes.

#### **C. Will Call Tickets:**

Will Call Service will take place from the Will Call Window located near Gate A. This service will include:

- a.) Pre-paid individual ticket pick-up
- b.) Pre-paid group purchase

#### **D. Consignment Tickets:**

Consignment tickets will be sent to those schools that emailed Megan Masias their ticket request confirmation by **Tuesday, November 24<sup>th</sup> and Thursday, December 3<sup>rd</sup>**. Tickets, along with the consignment ticket agreement, will be shipped through FedEx and will arrive at the school office on Monday, November 30<sup>th</sup> and Monday, December 7<sup>th</sup>. Each school that receives tickets must fax back the completed consignment ticket agreement to Megan Masias at 407-649-2072 by **5:00pm on Monday, November 30<sup>th</sup> and Monday, December 7<sup>th</sup>**. Please note that once the school signs off on the tickets, the school will be held responsible for the tickets, along with payment of the tickets. It is the school's responsibility to turn in the extra tickets not sold, along with any payment for the tickets sold at the time they check in at the LOC headquarters prior to their Championship game. **Team credentials will not be distributed unless the LOC receives all unsold tickets and payment for the sold tickets.** Please note, each classification has a minimum amount of tickets they can receive. Once the original amount has been sold, schools can place a request with Megan Masias for additional tickets. The LOC will only accept cash or check for the payment of sold consignment tickets. Checks can be made out to the Central Florida Sports Commission.

### 4. Seating:

#### **A. Home and Away Team Seating:**

Fans for the designated "home" team will sit in the west stands, and fans for the designated "away" team will sit in the east stands, as determined on the FHSAA bracket.

In the Class 1A, Class 2A, Class 5A and Class 7A championship games, the school on the upper line of the bracket shall be designated the home school. In the Class 3A, Class 4A, Class 6A and Class 8A championship games, the school on the lower line of the bracket shall be designated the home school.

Seating will be encouraged in lower levels between the thirty-yard line markers, except for designated disabled and companion seating, as noted below. South End Zone seating will not be open. Ushers will direct spectators to the proper areas.

**B. Disabled and Companion Seating:**

There are disabled and companion seats located throughout the stadium. Disabled seating may be found throughout the lower bowl. Tickets for patrons with disabilities may be purchased through the Amway Center box office, by phone through Ticketmaster 800.745.3000 or [Ticketmaster.com](http://Ticketmaster.com).

**C. Bands:**

The “home” team will sit in the west stands, and the “visiting” team will sit in the east stands. The Band Coordinators will escort the bands to their respective locations, which are listed below. **The bands are permitted to play post game but must stop at the start of the awards ceremony.**

Home Team

December 4<sup>th</sup> and 5<sup>th</sup> - Section 137

December 11<sup>th</sup> and 12<sup>th</sup> – Sections 141/143

Visiting Team

December 4<sup>th</sup> and 5<sup>th</sup> – Section 105

December 11<sup>th</sup> and 12<sup>th</sup> – Section 101/151

**5. Parking:**

**A. General Parking:**

The commuter parking lots are located in the surrounding area of the Orlando Citrus Bowl. The fee to park will be \$10.00.

Please obey all parking restrictions to avoid being ticketed or towed. Unless you hold a handicap-parking permit do not park in handicap spaces.

**B. Reserved Parking:**

There are two parking lots reserved for the following:

Lot G –Special Guest, Media, Volunteer, and Administrators Parking

Lot J - FHSAA, LOC, and Sponsor Parking

**C. Football Bus Parking:**

Team buses will park inside the team bus compound located on the south side of the stadium near the team locker rooms. The “home” team will park in the west team bus compound and the “visiting” team will park in the east team bus compound. Team buses will have access to the team bus compound two hours prior to game time. If team buses arrive earlier than two hours prior to game time they may park in the team bus waiting area located in parking lot C. Please note, each team is allowed a maximum of 2 team buses and 1 equipment truck inside of the team bus compound. Teams are allowed 1 police vehicle that may park directly outside of the team bus compound gate. Only individuals that have credentials are permitted in vehicles once entered through the team bus compound. All other vehicles will be required to pay for parking in the spectator parking lots. Please note, spectators are not allowed to enter or congregate in front of the bus compound gates as this area is an active street. It is highly encouraged that each school designate an area off property for spectators to be re-united with players post game.

**D. Band Bus Parking:**

One band equipment bus will be allowed to park in the team bus compound. The “home” team will park in the west team bus compound and the “visiting” team will park in the east bus compound. Band buses will park on Colyer Street. Access Colyer Street from Orange Blossom Trail and park the bus facing west. Bands will walk to Orlando Citrus Bowl and enter through the Southeast Gate.

**E. Cheerleader Parking:**

If cheerleaders arrive together by bus will park on Colyer Street. Access Colyer Street from Orange Blossom Trail and park the bus facing west. If cheerleaders arrive separately they will be required to park on their own and pay for parking in the spectator parking lots. If cheerleaders arrive separately, please coordinate a meeting location outside of the varsity club. At that time, the coach and only the coach can pick up the credentials in the Varsity Club and then escort the squad through the East Breezeway, located between Gate C and Gate D.

**F. Handicapped Parking:**

There is a reserved parking lot for handicap parking permits, located in lot 10. A current valid handicap-parking permit must be displayed to use these spaces. The fee to park will be \$10.00.

**G. Bus Parking:**

Bus parking will be located on Long Street between S Rio Grande Avenue and Tampa Avenue. Access Long Street from Orange Blossom Trail and park the bus facing west. The fee to park will be \$50.00. **Please make checks payable to the City of Orlando.**

*\* Refer to page 38 for a parking lot diagram*

**6. Admission to Games:**

**A. Spectators:**

For your safety and the safety of others, every person entering the Orlando Citrus Bowl for the 2015 FHSAA Football Finals are subject to search by law enforcement officers or other security personnel.

Please leave all coolers, book bags, backpacks or items larger than a small purse in your car. These items will not be permitted in the stadium. Please see the list of other prohibited items. Section 7:C.

Please note, spectators are not allowed to enter or congregate in front of the bus compound gates as this area is an active street. It is highly encouraged that each school designate an area off property for spectators to be re-united with players post game.

Gate entrances for ticketed spectators will vary based on the weekend, day, and time of the game.

*For further information on gate entrances please refer to page 12.*

**B. Individuals with Credentials:**

Football team members and coaches arriving on team buses will enter the stadium through the team bus compound. All other school officials arriving separately will enter through the Varsity Club. Only the athletic director, principal or head coach of each participating school is permitted into the Varsity Club to pick up the team’s sideline credentials and to check in each member of the team.

The Varsity Club is located between Gate C and Gate D, in the main office building on the 1<sup>st</sup> floor. It will open at 10:00am each Friday and Saturday.

**a. Football Team**

- A. All team members must be wearing a football jersey and be lined up in a single file line to be checked off from the team roster submitted to the FHSAA in order to enter the locker room. Only 60 athletes permitted in the locker room.
- B. Coaches and other support staff must be wearing proper credentials and credentials must be visible to gain access to locker rooms. **Teams will not be permitted into the locker room prior to 11:00am for a 1:00pm game and 5:00pm for a 7:00pm game.**
- C. Teams will be provided the following credentials. **The awards presentation sheet must be turned in at credential pick up or credentials will not be distributed.**
  1. *Sideline and Coaching Booth* – Twenty-four (24) credentials for use by coaches, managers, and student-athletes not in uniform. This will grant access to the team bench, coaching booth and sideline. Please note, only 8 individuals are allowed in the coaching booth at one time.
  2. *Videographer* – Two (2) credentials for use by the school's official team videographers. This will grant access to the team video room located on the press box level and field access in designated areas. Any on-field videography must take place from behind the yellow line field marking, except during the post-game interview period.
  3. *Coaches spouses / guests* - Six (6) general admission tickets for use of coach's spouses and/or guests. **The LOC will hold these allotted tickets for coaches; however, the coach must provide the name of each person picking up their individual ticket. The ID of the individual will be checked when they sign the appropriate log at the East Breezeway, located between Gate C and Gate D.** This will grant complimentary general admission to their championship game. This will not grant field access.

**b. Medical**

- A. One certified athletic trainer will be available to assist each team 90 minutes prior to kick-off and will remain on the sideline. A doctor and EMTs will also be available.
- B. Teams will also be provided the following medical credentials:
  1. *Team Doctor*: One (1) credential for use of team doctor. This will grant access to the team bench and sideline.
  2. *Team Athletic Trainer*: One (1) credential for use of team athletic trainer. This will grant access to the team bench and sideline.

**c. Law Enforcement**

- A. Each school will be permitted three (3) law enforcement escorts, in uniform, on the sidelines. Permission will be granted provided all escorting officers with the City of Orlando Police Department officers for crowd control. Please note, City of Orlando Police Department has full jurisdiction in and around Orlando Citrus Bowl.

**d. Team Administration**

- A. The LOC will provide complimentary parking for up to 5 school administrators who do not travel on the team bus. The school must provide the names of the selected administrators on the credential form. The names will be placed on a parking list for parking lot G and the administrators must show proper identification (ex. Driver's license) to access parking lot G.



- B. Teams will be provided the following team administration credentials:
  - 1. *Team Administrators and Guests* - Six (6) credentials for use by (principal, assistant principal, athletic director, etc.). This will grant access to the sideline and access to the FHSAA Hospitality Suite.
- e. **Cheerleaders**
  - A. Cheerleaders in uniform and one mascot in uniform will be admitted without charge for the game in which their school's team directly participates.
  - B. Teams will be provided the following cheerleading credentials:
    - 1. *Coaches/Chaperones*: Two (2) credentials for use by coaches or chaperones. This will grant access to the sideline.
- f. **Band and Drill Team**
  - A. Only those members in uniform and performing will be admitted free. All others must purchase a ticket.
  - B. The LOC band coordinator will be responsible for distributing credentials to the participating bands.
  - C. Teams will be provided the following band and drill team credentials:
    - 1. *Band Director*: One (1) credential for use of the band director. This will grant access to the sideline and access to the press box.
    - 2. *Chaperones*: One (1) chaperone per 10 band members participating will be granted a credential. This will grant access to the sideline.
- g. **School Administration**
  - A. Each school will be required to assign a school administrator who will be in attendance at the championship game and will assume responsibility for their school and their school representatives before, during and after the game.
  - B. Teams will be provided the following school administration credentials. Credentials will only be issued personally to this administrator upon their arrival and check-in at the varsity club.
    - 1. *School Administrator* – Two (2) credentials for use by assigned school administrator. This will grant access to the sideline and access to the FHSAA Hospitality Suite.

The credential form is located on page 29 and it must be returned to the LOC by fax (407-649-2072) or e-mail [mmasias@centralfloridasports.org](mailto:mmasias@centralfloridasports.org) no later than **4:00 P.M. on December 2, 2015 and December 9, 2015.**

All teams participating in the 2015 FHSAA Football Finals must take part in a **mandatory conference call** to be scheduled for **December 1<sup>st</sup> and December 8<sup>th</sup>**. Each school must be represented by the following: Principal, Athletic Director, Head Football Coach, Band Director, Cheerleading Sponsor and School Resource Officer. If someone other than the athletic director or head coach coordinates the team athletic trainers, that person should join this conference call. Please use one phone that has speakerphone capabilities. The call will begin promptly at 10:00am. The conference call number is 1-888-850-4523 and the conference code is 690763.

**C. Bus Drivers**

Bus drivers will receive complimentary admission if they stay in the facility once they enter with team or band buses. If the bus driver leaves the facility they will then be responsible for purchasing a ticket.

**D. Game Viewing by Teams Not Competing:**

Teams competing in the Football Finals that wish to attend a game in which they are not competing must contact the LOC prior to the game. Only team members on the varsity team roster will be

admitted. Sub Varsity team members must purchase a ticket. In addition, only 20 personnel will be admitted for free. To obtain this courtesy admission, the team must complete and fax back the game viewing form (page 35) to Megan Masias at (407) 649-2072 no later than **4:00 P.M. on December 2, 2015 and December 9, 2015**. Preference for complimentary admission will be given to teams competing in a championship game prior to or immediately after the game they wish to view. To obtain admission, the team must check in at the East Breezeway, located between Gate C and Gate D. All players must be wearing their team jersey or warm ups.

#### **E. Hospitality:**

All hospitality credential-holders will enter the stadium through any open gate after obtaining credentials at the Operations Center located in the Varsity Club. Access to the all hospitality suites will be by the West Press Box Elevator.

#### **Please Note:**

**Any team that wishes to have food, drink, or other hospitality delivered to the Citrus Bowl must first receive approval from the LOC. Additionally, team social events (lunch, dinner, etc.) on any Orlando Citrus Bowl property (parking lot, fields, etc.) will not be permitted.**

#### **Media Credentials and Student SID's:**

The FHSAA will produce and issue all media credentials. All working media representatives are required to secure credentials by submitting a request directly to the FHSAA Office by using the online form at [www.media.fhsaa.org/departments/media](http://www.media.fhsaa.org/departments/media) by 12 p.m. (noon) on Wednesday, Dec. 2, 2015 (Classes 1A-4A) and by 12 p.m. (noon) on Wednesday Dec. 9, 2015 (Classes 5A-8A). Media credentials may be picked up and signed for in the west breezeway, located between Gates C and D.

Each media representative with a credential will be issued one complimentary copy of the published flipcard, which contains information provided to the FHSAA from the participating teams.

Each school will be allowed one (1) student photographer or reporter to be credentialed for access to the sidelines and press box. To obtain this credential, the athletic director must use the FHSAA's online credential request system located at the following address.

[www.fhsaa.org/departments/media](http://www.fhsaa.org/departments/media). This is only for student members of your school's media and not adults. If your school is unable to provide a student member of the media but still wants coverage from the finals, contact Corey Sobers, FHSAA Public Relations Specialist, at (352) 372-9511 ext. 350 or [csobers@fhsaa.org](mailto:csobers@fhsaa.org) for possible arrangements. The online request is to be submitted by 12 p.m. (noon) on Wednesday, Dec. 2, 2015 (Classes 1A-4A) and by 12 p.m. (noon) on Wednesday Dec. 9, 2015 (Classes 5A-8A). Walk-ups will not be accepted.

Media credentials are intended for the purpose of gaining access to the press box and playing field. Field access will be limited to the area behind the yellow lines designated for photographers and videographers during the game. This pass does not permit access to the team bench area, locker rooms, dressing rooms or field of play. However, all media credentials will permit access to the field for a 10-minute interview period that begins upon completion of the game and ends at the start of the award ceremonies. This interview time period will be strictly enforced.

Snacks and beverages (hot and cold) will be available; two meals per day are planned.

Admission of media representatives to the press level will not be permitted without proper press credentials.

#### **G. Lost Credentials:**

Once a credential is issued and signed for, should that credential be lost or destroyed the credential may be replaced at the discretion of the LOC. Lost sideline credentials will not be replaced.

## **7. Admission, Access, and Conduct Standards:**

### **A. Access to the Playing Field:**

No one will be allowed access to the playing field or the sidelines without proper credentials. This includes access by spectators prior to, during, or after the game. Anyone entering the field without proper credentials is subject to ejection from the stadium and/or arrest.

The only beverage permitted on the field is water. All other food and beverage is not permitted, this includes gum and sunflower seeds.

### **B. Re-Entry to stadium:**

No re-entry to the stadium will be permitted. Spectators must purchase a ticket to re-enter the stadium.

### **C. Prohibited Items:**

Food/drinks containers, bottles, cans, thermoses, ice bags, ice chests, any artificial noise making devices, tripods, professional cameras with detachable lenses, flags, umbrellas, back packs, carry bags, seat cushions, or any items deemed hazardous by FHSAA, Orlando Citrus Bowl or LOC will not be allowed in the stadium. Small hand held cameras and strollers that can fold and fit underneath a seat are permitted. Law enforcement officials have the right to inspect any item at any time for the purpose of spectator safety.

Prohibited items must be returned to car or disposed of before entering the stadium. There are no provisions to check items at the gates.

Alcoholic beverages and illegal substances are strictly prohibited. Smoking is prohibited in all areas of the Orlando Citrus Bowl Stadium.

### **D. Firearms, Explosive Devices, Knives, and Other Weapons:**

No firearms, explosive devices (including fireworks and cannons), knives, or other weapons are permitted.

### **E. Access to field by Marching Bands:**

Bands will be permitted on the playing surface without credentials for half time performance(s) only. Permission must be obtained by the LOC prior to arrival at the stadium. In the event of rain or should the field be wet from previous rainfall, no access to the field will be permitted, even though that permission may have been previously granted. No post-game access to the field will be permitted. The LOC Band Coordinator has been assigned to assist marching bands with field access. Bands must follow the directions of the LOC Band Coordinator when accessing the stadium.

In the interest of fan and band participant safety, bands should not exit the stadium until fans have cleared the exits. At no time should bands march through crowd areas.

Please note, halftime performances will be limited to no more than 7 minutes per team. Please coordinate performance schedule between school band and cheerleaders.

### **F. Signs and/or Banners:**

According to the 2015-2016 FHSAA Football Finals Manual: General Regulations and Policies rule: 208.06, the display of signs, banners, placards or similar items at matches in the state series is permitted, provided:

1. They are in good taste and reflect good sportsmanship in their message and use;

2. That they reflect identification and encouragement to participants and their school, players or community, and make no reference to the opposing team, its school, players, or community;
3. They are not displayed on the field, or in a manner which interferes with play;
4. They do not obstruct the view of participants or spectators;
5. And they are not safety hazards. In addition, they may not cover banners and decorations placed by the FHSAA or the Host Organization, LOC.
6. They are not prohibited by facility management.

## II. FACILITY AND GAME OPERATIONS

### **1. Rules and Officials:**

National Federation of High School Football (NFHS) rules, unless modified by the FHSAA, shall be strictly observed. The FHSAA staff will coordinate with the LOC all aspects of game management. The FHSAA will provide all officials and clock operators for the championship series. No team access is permitted in this area.

The 2015 FHSAA Football Finals are also subject to the General Regulations and Policies State Series Terms and Conditions outlined in the *2015-2016 FHSAA Football Manual: General Regulations and Policies* (with any subsequent amendments or corrections).

Contact Frank Beasley, Administrator for Football with the FHSAA at (352) 372-9551 ext. 250 or contact him by e-mail at [fbeasley@fhsaa.org](mailto:fbeasley@fhsaa.org) should you have questions concerning rules, general regulations, and/or policies. A copy of this manual may be downloaded from the FHSAA web site.

### **2. Playing Field:**

The Orlando Citrus Bowl will be responsible for the preparation of the playing field to meet NFHS Regulations. Field markings will be those stated by the FHSAA. The FHSAA logo will be permitted on the field provided that the FHSAA supply the template to the Orlando Citrus Bowl field maintenance personnel no later than November 13, 2015. The Orlando Citrus Bowl will supply goal posts that meet NFHS regulations.

### **3. Equipment and Facilities:**

Boone High School will provide the Orlando Citrus Bowl down markers, yard markers, chains, and corner markers. Additionally, the Orlando Citrus Bowl will provide the scoreboard, playing field, matrix board and P.A. system. The clock operator shall be provided by and paid for by the FHSAA. Teams must provide their own warm-up footballs. Teams must also provide their own game balls and must be Spalding J5V Advance and/or Spalding TF-SB1. Game balls will be inspected by officials prior to each game.

### **4. Gatorade Coolers, Towels, and Squeeze Bottles:**

The FHSAA currently has an agreement with Gatorade© to be the official isotonic drink of the FHSAA Football Finals. Gatorade© shall provide drink mix, coolers, and cups to the LOC for use during the 2015 FHSAA Football Finals. The LOC will place four coolers in each team box area. Two coolers will contain Gatorade© and two coolers will contain ice water. Gatorade© may also provide squeeze bottles and towels. If so, no other squeeze bottles or towels shall be used on either sideline.

If neither squeeze bottles nor towels are provided by Gatorade©, white towels and/or generic bottles (no corporate names or logos) may be used.

#### **5. Locker Rooms:**

The Florida Citrus Bowl will provide security in the locker room areas. The security personnel will remain in the locker room to ensure the safekeeping of team equipment, supplies, and personal possessions.

The designated “home” team will be assigned to the West locker room and the designated “visiting” team will be assigned to the East locker room. Both have access to restrooms and shower facilities.

For all game days, participants in the 1:00pm game shall have access to the locker rooms from 11:00am-4:45pm. Pending actual game time completion of the 1:00pm game, teams participating in the 7:00pm game shall have access to the locker rooms from 5:00pm-10:45pm.

#### **6. Coaches Viewing Areas:**

The coaches viewing boxes are located in the Press Box. Access can be gained through the Press Row elevator located on the west end of the Orlando Citrus Bowl at Gate E. The home team coaches’ box will be located in booth #7. The visiting coaches’ box will be located in booth #4.

\*Refer to page 39 for a diagram of the Press Box

#### **7. Premises:**

##### **A. Ticket Booth:**

The ticket booth located at Gate A will be open for both weekends.

##### **B. Gates:**

Listed below is the current plan for entrances for the FHSAA Football Finals. Please note that gate entrances are subject to change based on attendance count.

Friday, December 4, 2015

1:07 PM Championship Game – Gate A & B

7:07 PM Championship Game – Gate A & B

Saturday, December 5, 2015

1:07 PM Championship Game – Gate A & B

7:07 PM Championship Game – Gate A & B

Friday, December 11, 2015

1:07 PM Championship Game – Gate A & B

7:07 PM Championship Game – Gate A & B

Saturday, December 12, 2015

1:07 PM Championship Game – Gate A & B

7:07 PM Championship Game – Gate A & B

**C. Game Operations Center:**

The Varsity Club will serve as the command and communication center. All aspects of game support will be directed from here. All volunteers, team personnel, cheerleaders, and chaperones must sign in here. VIP credential pick-up will also be conducted here. FHSAA All Series passes will **NOT** be accepted here but will be accepted in the East Breezeway. It will open at 10:00am each Friday and Saturday.

**D. Areas Not to be Used:**

The 300 levels are not to be accessed.

**E. Restrooms:**

Restrooms are located throughout all levels of the Orlando Citrus Bowl.

**F. Concession Stands:**

Concession stands are located throughout the Orlando Citrus Bowl.

**G. Novelty Sales:**

Merchandise will be sold inside the Orlando Citrus Bowl by Team IP, the officially licensed merchandized of the FHSAA

**8. Sidelines:**

Control of access to the sidelines is a critical aspect in providing an environment conducive to a well-run series of championship games. Participants must follow the rules and regulations concerning the use of this area and the field of play.

**A. Permitted Personnel:**

Individuals permitted on the sidelines during the game must be assigned and recognized as working game staff members of the media, security staff, team personnel, or game day operations staff.

Teams may consist of no more than sixty (60) players in uniform and twenty-four (24) coaches and support staff.

**B. Credentials required:**

Each individual on the sideline must wear a visible credential issued by the LOC. All credentials needed for Centroplex staff or Orlando Citrus Bowl vendors must be requested and approved by the Orlando Citrus Bowl Stadium Operations Coordinator. LOC credentials must be issued through the Operations Center located in the Varsity Club. Team members, cheerleaders, and band members in uniform are the only exception to this rule.

**C. Restricted Access:**

Anyone not possessing appropriate credentials will be denied access to the playing field; the marked team bench areas and other restricted areas anytime after the competition begins. These restrictions apply to halftime and timeouts.

**D. Photographer and Videographer Restrictions:**

Working press possessing appropriate credentials may not interfere with the activities within the marked bench areas nor may they interfere with the view of any ticketed spectator. On-field photography and videography must take place from behind the yellow line field marking, except during the post-game interview period.

**E. Problem Resolution:**

Anyone requiring resolution of issues regarding sideline access, credential availability, or policy should contact the LOC Operations personnel in the Varsity Club. All decisions by the LOC to uphold established policy will be final.

**F. Revocation of Privileges:**

Anyone found abusing the use of credentials is subject to the revocation of credential privileges and/or eviction from the premises. Infractions covered by this rule include but are not limited to:

illegally issuing or transferring credentials to persons not directly involved with game duties, violating credential policies outlined above, or breaking other rules governing the safe and fair operation of the championship games.

**G. Facility Tour:**

The Orlando Citrus Bowl will host site facility tours from 2:00pm-4:30pm on Thursday, December 3<sup>rd</sup> and Thursday, December 10<sup>th</sup>. The tour will be 30 minutes long with only two teams at each set time. This is not a practice and no equipment (spikes, balls, etc) will be permitted on the field. Please note, teams that are competing against each other will not be scheduled during the same walk thru session. Also, due to field preparation there may be limited access to the field. Parking for the tours will be at parking lot J and a facility or LOC representative will meet teams at the entrance of the west team bus compound. Please contact Megan Masias at [mmasias@centralfloridasports.org](mailto:mmasias@centralfloridasports.org) by **4:00pm on December 2<sup>nd</sup> and December 9<sup>th</sup>** to schedule your tour.

### III. SECURITY

**1. Uniformed Security:**

Uniformed security will be provided by the Orlando Police Department, and the Orlando Citrus Bowl will provide yellow shirt event security.

All issues involving fan or crowd control should be directed to the nearest yellow shirt event security personnel for conflict resolution.

It is requested that should schools bring resource officers or other law enforcement officials that:

1. The name of these officers be given to the LOC no later than **4:00 P.M. on December 2<sup>nd</sup> and December 9<sup>th</sup>**;
2. That the officers come in uniform;
3. And that the officers, upon arrival at the stadium, check in at the LOC Headquarters, which is located in the Varsity Club.

These officers will be asked to assist in the prevention of spectators storming the field at the end of the game.

**NOTE: Because of past rowdiness and storming of the field, the FHSA has instructed the LOC that storming the field or other similar activities must be stopped. Accordingly, the LOC in conjunction with the Orlando Citrus Bowl and event security, have determined that any unauthorized person entering the field without proper credentials will be SUBJECT TO IMMEDIATE ARREST.**

We find it unfortunate that this has become an issue. Spectators should be encouraged to celebrate their team's victory in the stands, and not risk injury to players, coaches, and volunteers or damage to the field or goal posts with unruly behavior, including rushing the field. In addition, spectators are not permitted to stand and/or jump on the seats. Anyone standing or jumping on the seats is subject to ejection from the stadium.

In addition to these security measures, please note, in the game day schedule supplied with this manual, that a “two minute warning” has been included. The P.A. Announcer will make at least two or three announcements during the last five minutes of the game instructing fans to stay off the field. The stadium announcer will also make similar announcements prior to the completion of the game.

## IV. MEDICAL

### 1. Emergency Medical Services:

Coordination of the spectator and participant Emergency Medical Service (EMS) for the Orlando Citrus Bowl is the responsibility of the Orange County Fire/Rescue Chief of Operations. Transport of any injured person(s) will be provided by Orange County EMS as follows: The Emergency Medical Team shall evaluate and administer care to any injured or ill person(s). If needed, Orange County Fire/Rescue will transport injured or otherwise ill person(s).

The Orlando Citrus Bowl will have a first aid station located on the Southeast end of the stadium. They will also provide roving medical personnel. They will be located throughout the stadium.

A gurney and EMS personnel with ALS support will be in place throughout each game on field level for athletic care.

### 2. Athletic Trainers:

Teams are encouraged to bring their team’s doctor and/or athletic trainer(s) to provide pre-game ankle taping and other injury prevention regimen that they usually employ. **These athletic trainers must provide their own tape and other supplies.** Certified athletic trainers will be available for evaluation of injuries, pre-game taping, re-taping, and other services. Volunteers will assist teams prior to the game in obtaining ice, Gatorade®, etc. Teams must provide their own towels, as these will not be available on site.

### 3. Other Medical:

An on-site physician will be coordinated through the LOC. In the event of a medical emergency, the attending physician will refer the patient to the proper medical facility. X-ray and other referrals will likely be sent to Orlando Regional Medical Center by the attending physician. Orange County Fire/Rescue will provide transport.

## V. INCLEMENT WEATHER

Should inclement weather be imminent, a designated personnel member assigned by the Orlando Citrus Bowl shall monitor weather conditions with available Internet weather services. In the event of lightning within six (6) miles of the stadium, this individual shall notify the LOC Operations Manager.

The LOC Operations manager will inform the LOC Officials’ Attendant and notify the PA Announcer to stand by to issue a safety warning to the spectators.

The Officials’ Attendant shall notify the Referee (White Hat) to suspend play.



Upon suspension of play, the PA Announcer shall read the appropriate script that informs spectators of the suspension of play and directs them to exit the stands for their safety. Teams and all sideline personnel shall immediately leave the field and return to their locker room.

Play shall remain suspended until a thirty (30) minute period has passed since the last lightning strike, and until the individual has informed the LOC Operations Manager that no further strikes are indicated on the monitor.

## VI. AWARDS AND PRE-GAME INTRODUCTIONS

### **1. Pre-Game Warm-ups and Meetings:**

- A. The playing surface will be opened to both teams 90 minutes prior to kickoff. The pre-game clock will begin its countdown 60-minutes prior to kickoff. When the pre-game clock reaches 30:00 minutes teams will be required to leave the field. Teams will warm up on the playing surface located to the right of their bench.
- B. Teams will have approximately fifteen (15) minutes in their dressing rooms after leaving the field following pre-game warm-ups. Team will be required to assemble in their respective tunnels fifteen (15) minutes prior to kickoff for the introduction of starters.

### **2. National Anthem**

The colors will be presented and the National Anthem will be sung by a local entertainer or played from the PA system at the 16-minute mark. After completion of the National Anthem, team captains should report to the 50-yard line for the official coin toss.

### **3. Introduction of Starters:**

- A. The offensive and defensive starters for both teams will be introduced in numerical order.
- B. A member of the FHSAA staff will meet with both head coaches during pre-game warm-ups to review the projected starting lineups that have been previously submitted to the FHSAA Office. Any changes will be recorded and radioed up to the PA announcer.
- C. **The visiting team must report to their tunnel at the 15:00 mark on the game clock.** A member of the FHSAA staff or host committee will meet the team in their designated locker room to assist with their line-up. The team will be introduced as follows.
  - a. All non-starting players and assistant coaches on FHSAA staff's cue will run onto the field and to their sideline.
  - b. Each of the starters (whether offensive or defensive) will be introduced individually in numerical order regardless of position. As a player's name and number is called, he will trot from the tunnel holding, **not wearing**, his helmet to join his team on the sideline.
  - c. The head coach will be introduced and will trot from the tunnel to join his team on the sideline.
- D. **The home team must report to their tunnel at the 15:00 mark on the game clock.** A member of the FHSAA staff or host committee will meet the team in their designated locker room to assist with their line up.
  - d. All non-starting players and assistant coaches on FHSAA staff's cue will run onto the field and to their sideline.

- e. Each of the starters (whether offensive or defensive) will be introduced individually in numerical order regardless of position. As a player's name and number is called, he will trot from the tunnel holding, **not wearing**, his helmet to join his team on the sideline.
- f. The head coach will be introduced and will trot from the tunnel to join his team on the sideline.

#### 4. Coin Toss

The official coin toss shall take place at the 3-minute mark prior to the kickoff of each game. Only the game officials, team captain(s) and the FHSAA approved staff will be allowed on the 50-yard line for the coin toss. Introductions and the coin toss shall take place. Team captains, officials, and FHSAA staff shake hands and return to the appropriate sidelines.

#### 5. Post-Game Interviews:

Post-game interviews of players and coaches by media representatives will take place on the field following the conclusion of the game. Ten (10) minutes will be placed on the game clock for this purpose. Once the 10-minute interview period has expired, interviews will cease until the conclusion of the awards ceremony.

#### 6. Post-Game Awards Ceremony:

- A. The post-game awards ceremony for both champion and runner-up teams will take place on the field in front of each team's respective bench area following the 10-minute interview period. Individual medallions and the team trophy will be presented first to the runner-up team and then to the champion team. Once the runner-up team presentations are completed, the runner-up team may quietly and orderly leave the field.
- B. Both teams are required to complete an "Awards Presentation Lineup Sheet" on which the names of those individuals who will receive individual medallions are to be listed. **The awards presentation sheet must be turned in at credential pick up or credentials will not be distributed.** Names are to be listed in the following order: (1) head coach; (2) assistant coaches; and (3) players in numerical order. Do not list the names of managers, trainers, statisticians, doctors or other team attendants. In order that the awards ceremony can be completed in a timely manner, their names will not be called. You also must name on the form the administrator(s) from your school (i.e. principal, athletic director, etc.) who will assist in the awards presentation.
- C. The FHSAA will provide 80 medallions for presentation. The "Awards Presentation Lineup Sheet" has room for the names of 80 recipients. Do not list more than 80 names on the form. Do not write in more than one name in each blank. The public address announcer will be instructed to cease announcing names after the 80<sup>th</sup> name has been called. The "Awards Presentation Lineup Sheet" must be completed and turned in at credential pick up or credentials will not be distributed.
- D. School and FSHAA photographers with appropriate credentials will be permitted to photograph awards ceremonies. **No family members or other non-credentialed personnel will be permitted access to the field for photographs.** Every effort will be made to position the awards stands and activities so that it may be photographed easily from the grandstands.

**7. Timeouts and Breaks Between Quarters:**

Bright House Sports Network will be broadcasting all eight championship games live for the 2015 FHSAA Football Finals. Consequently, we will be making some adjustments to the number and length of timeouts, as well as breaks between quarters.

**A. Charged Timeouts:**

Timeouts taken or charged to either team will be a full 60 seconds in duration.

**B. TV Timeouts:**

Bright House Sports Network has the option of taking one 90-second uncharged television timeout per quarter. The television timeout will be granted by the referee, as directed by the "red hat", at the dead ball following the change of possession that occurs nearest the 6:00 minute mark of the quarter. The FHSAA will require that Bright House Sports Network declare whether it will avail itself of these TV timeouts in advance of the game. Each coach will be notified of Bright House Sports Network intent during pre-game warm-ups.

**C. Breaks Between Quarters:**

The break between the first and second quarters and the third and fourth quarters will be extended from 60 seconds to 90 seconds.

**D. Halftime:**

The halftime will be 20 minutes in length. Should there be any deviation in this, both head coaches will be notified during pre-game warm-ups, if not earlier.

**VII. STADIUM CLEARING PLAN**

To facilitate the turnover of fans between the first and second games during each day of competition, the following plan will be used:

**1. Transition:**

No admission to the second game will be permitted until the previous game spectators have cleared the stadium seats. The FHSAA contract requires clearing of the stadium at the conclusion of each game, each day. Stadium clearing will be done by ushers, on-field security volunteers, yellow shirt security, and OPD personnel.

At the conclusion of the awards ceremony for each game, spectators will exit the stadium through the gates they entered (Refer to the previous section, stadium entry, regarding gate entrances).

**2. Locker Rooms:**

At the conclusion of the awards ceremony, teams have thirty-five minutes to clear the locker rooms and to be off Orlando Citrus Bowl property. Teams will not be permitted back into the locker rooms after they have been cleared.

The next game's participants may enter the locker rooms one and one-half hours prior to the start of their game. They will not be allowed to enter the locker rooms while the previous game's participants are still inside.

If needed, equipment will be stored in an auxiliary room until the next game's teams are allowed to enter the locker rooms.

**3. Other Factors:**

To encourage spectators to leave the following will be done:

- a) Public Address Announcements need to be made to ask the spectators to leave as soon as the awards ceremony has been completed.
- b) Directional signage and barricades need to be placed to direct traffic flow from the stadium.
- c) T-shirt and placard sales will be located outside the stadium by Gate A, allowing spectators a chance to make purchases without blocking entry gates. Placements of these vendor areas are subject to coordination between the FHSA vendor and the Orlando Citrus Bowl Personnel.

## VIII. HOUSING

Rooms have been blocked at special rates at the following properties for participants and spectators of the FHSAA Football Finals. Please call the numbers below to make your reservations. When calling ask for the **FHSAA State Football Finals** to receive the published rates. If your schools selects the option to stay at a property not endorsed by the Central Florida Sports Commission, your school may forfeit \$250.00 from your schools total travel reimbursement.

### **Cabana Bay Resort**

Rate: \$115 per night  
6550 Adventure Way  
Orlando, FL 32819  
Phone: 407-503-4000  
<http://www.loewshotels.com/cabana-bay-hotel/>  
*Distance From the Orlando Citrus Bowl: 8 Miles*

### **Hawthorne Suites by Wyndham – International Drive**

Rate: \$69 per night  
7975 Canada Avenue  
Orlando, FL 2819  
Phone: 407-345-0117  
<http://www.hawthorn.com/hotels/florida/orlando/hawthorne-suites-by-wyndham-orlando-international-drive/hotel-overview?WID=LC:BH:20150901:Rio:Local>  
*Distance from the Orlando Citrus Bowl: 8.1 Miles*

### **CoCo Key Hotel and Water Resort – International Drive**

Rate: \$65 per night  
7400 International Drive  
Orlando, Florida, 32819  
Phone: 407-351-2626  
<http://www.cocokeyorlando.com>  
*Distance from the Orlando Citrus Bowl: 9 Miles*

### **Comfort Suites – UCF**

Rate: \$83 per night  
12101 Challenger Parkway  
Orlando, FL 32826  
Phone: 407-737-7303  
<https://www.choicehotels.com/florida/orlando/comfort-suites-hotels/fl061>  
*Distance from the Orlando Citrus Bowl: 15.5 Miles*

### **Hilton Orlando Altamonte Springs**

Rate: \$83 per night  
350 Northlake Blvd  
Altamonte Springs, FL 32701  
Phone: 407-830-1985  
[hiltonorlondonorth.com](http://hiltonorlondonorth.com)  
*Distance from the Orlando Citrus Bowl: 10.9 Miles*

### **DoubleTree by Hilton – Orlando Downtown**

Rate: \$109 per night  
60 South Ivanhoe Blvd.  
Orlando, FL 32804  
Phone: 407-425-4455  
<http://www.doubletreeorlandodowntown.com/>  
*Distance from the Orlando Citrus Bowl: 3.10 Miles*

### **Sheraton-Maitland**

Rate: \$109 per night  
600 North Lake Destiny Road  
Maitland, FL 32751  
Phone: 407-660-9000  
<http://www.sheratonorlondonorth.com/>  
*Distance from the Orlando Citrus Bowl: 8.7 Miles*

### **Lake Buena Vista Resort Village & Spa**

Rate: \$119 per night  
8113 Resort Village Drive  
Orlando, FL 32821  
Phone: 866-401-2699  
<http://www.lbvorlandoresort.com/>  
*Distance from the Orlando Citrus Bowl: 16.1 Miles*

### **DoubleTree by Hilton – UCF**

Rate: \$83 per night  
12125 High Tech Avenue  
Orlando, FL 32817  
Phone: 407-275-9000  
<http://doubletree3.hilton.com/en/hotels/florida/doubletree-by-hilton-hotel-orlando-east-ucf-area-ORLOEDT/index.html>  
*Distance from the Orlando Citrus Bowl: 15.2 Miles*

### **Westgate Leisure Resort**

Rate: \$83 per night  
6950 Villa Costa Drive  
Orlando, FL 32821  
Phone: 407-239-8855  
<http://www.westgateresorts.com/leisure/>  
*Distance from the Orlando Citrus Bowl: 13.8 Miles*

### **Courtyard Marriott – Airport**

Rate: \$83 per night  
7155 North Frontage Road  
Orlando, FL 32812  
Phone: 407-240-7200  
<http://www.marriott.com/hotels/travel/mcoch-courtyard-orlando-airport/>  
*Distance from the Orlando Citrus Bowl: 10.9 Miles*

***All hotel room rates subject to applicable state and local taxes effective at the time of check in. Availability is not guaranteed at the published rates. Cut-off dates are approximately one week before each weekend of the event, but vary with each hotel.***

### IX. GAME DAY SCHEDULES

The following Game Day schedules for the 2015 FHSA Football Finals by classification is subject to change. All times are approximate.

#### Friday, December 4, 2015 Class 2A Game Schedule

Real Time	Game Clock	Activity
10:00 AM		Volunteers begin check in at the Varsity Club
10:30 AM		Will call and one ticket sales window sets up
		Official Dressing and meeting rooms open
		Hospitality volunteers arrive and set up hospitality
11:00 AM		Security sweep of building
		Parking attendants in place
		Ticket takers, on-field security, and ushers arrive
		Dressing facilities available to competing teams
11:15 AM		Ticket takers, on-field security, and ushers in place
11:30 AM		Ticket windows open
11:37 AM	90:00	Field available to teams
12:00 PM		Citrus Bowl Opens
		Hospitality room opens
12:15 PM		All officials in place
		PA announcer and game statistician in place
12:37 PM	30:00	Clock Operator starts 30 minute countdown on clock and pre-game warm up ends
12:35 PM	28:00	Scholar Athlete Award Presentation at mid-field
12:47 PM	20:00	Announcer begins pre-game script
12:47:30 PM	18:30	Presentation of colors on field
12:50 PM	17:00	Pledge of Allegiance
12:51 PM	16:00	National Anthem is performed
12:52 PM	15:00	Teams report to tunnel to line up for introductions (visitor first)
12:54 PM	13:00	Visiting team entrance followed by introductions of its starters
12:58:30 PM	8:30	Home team entrance followed by introduction of its starters
1:03 PM	4:00	Officials, captains proceed to midfield for ceremonial coin toss
1:04 PM	3:00	Official coin toss conducted at mid-field
1:05:30 PM	1:30	Teams take position on field for kickoff
1:06 PM	0:01	Reset game clock to 12:00. Referee signals ready for play.
1:07 PM	0:00	KICKOFF
2:00 PM	2:15	Half-time
3:15 PM	7:00	Ceremony volunteers to field with all awards and podiums. PA coordination volunteer to PA booth
3:18 PM	6:00	Principal or school representative must join their respective team on the sideline
3:25 PM	2:00	School representative from each school will make a public announcement informing the crowd to stay off the field of play and warn of the consequences. The 2 minute warning will be during the first clock stoppage after 2:30 is left on the clock
3:30 PM		Approximate GAME END time. Clock operator places 10:00 on clock for post game celebration and on-field interviews
3:40 PM		Approximate post game ceremony start time. On field interviews end
4:00 PM		Clear stadium. Stadium and field volunteers take breaks as crowd permits
4:45 PM		Locker Rooms cleared of 3A teams
5:00 PM		Locker rooms open for teams for 4A championship game
6:00 PM		Stands clear of 2A spectators. Gates open for 1A game

**Friday, December 4, 2015**  
**Class 1A Game Schedule**

Real Time	Game Clock	Activity
4:00 PM		Approximate. Clear stadium. Stadium and field volunteers take breaks as crowd permits
5:00PM		Locker Rooms available to teams for 1A championship
5:30 PM		Ticket takers, on-field security, and ushers back in place
		Playing surface open to competing teams
6:00 PM		Citrus Bowl Opens
		Gates open for 1A game
6:15 PM		All officials in place
		PA announcer and game statisticians in place
6:37 PM	30:00	Clock Operator starts 30 minute countdown on clock and pre-game warm up ends
6:35 PM	28:00	Scholar Athlete Award Presentation at mid-field
6:47 PM	20:00	Announcer begins pre-game script
6:48:30 PM	18:30	Presentation of colors on field
6:50 PM	17:00	Pledge of Allegiance
6:51 PM	16:00	National Anthem is performed
6:52 PM	15:00	Teams report to tunnel to line up for introductions (visitor first)
6:54 PM	13:00	Visiting team entrance followed by introductions of its starters
6:58:30 PM	8:30	Home team entrance followed by introduction of its starters
7:03 PM	4:00	Officials, captains proceed to midfield for ceremonial coin toss
7:04 PM	3:00	Official coin toss conducted at mid-field
7:05:30 PM	1:30	Teams take position on field for kickoff
7:06 PM	0:01	Reset game clock to 12:00. Referee signals ready for play.
7:07 PM	0:00	KICKOFF
8:00 PM	2:15	Half-time
9:00 PM		End ticket sales. Close booth operations
9:15 PM	7:00	Ceremony volunteers to field with all awards and podiums. PA coordination volunteer to PA booth
9:18 PM	6:00	Principal or school representative must join their respective team on the sideline
9:25 PM	2:00	School representative for each school to make a public announcement informing the crowd to stay off the field and warn of the consequences. The 2 minute warning will be during the first play stoppage inside of 2:30 minutes left on the clock
9:30 PM		Approx. Game End time. Clock operator places 10:00 minutes on the game clock for post game celebration and on-field interviews
9:40 PM		Post game ceremony start time. On-field interviews end
10:00 PM		Clear stadium. Stadium and field volunteers
		Stadium clean up begins
10:30 PM		Close Press box
		Close Varsity Club
10:45 PM		Stands clear of 1A spectators
11:00 PM		Dressing rooms clear of 1A competitors

**Saturday, December 5, 2015**  
**Class 3A Game Schedule**

Real Time	Game Clock	Activity
10:00 AM		Volunteers begin check in at the Varsity Club
10:30 AM		Will call and one ticket sales window sets up
		Official Dressing and meeting rooms open
		Hospitality volunteers arrive and set up hospitality
11:00 AM		Security sweep of building
		Parking attendants in place
		Ticket takers, on-field security, and ushers arrive
		Dressing facilities available to competing teams
11:15 AM		Ticket takers, on-field security, and ushers in place
11:30 AM		Ticket windows open
11:37 AM	90:00	Field available to teams
12:00 PM		Citrus Bowl Opens
		Hospitality room opens
12:15 PM		All officials in place
		PA announcer and game statistician in place
12:37 PM	30:00	Clock Operator starts 30 minute countdown on clock and pre-game warm up ends
12:35 PM	28:00	Scholar Athlete Award Presentation at mid-field
12:47 PM	20:00	Announcer begins pre-game script
12:47:30 PM	18:30	Presentation of colors on field
12:50 PM	17:00	Pledge of Allegiance
12:51 PM	16:00	National Anthem is performed
12:52 PM	15:00	Teams report to tunnel to line up for introductions (visitor first)
12:54 PM	13:00	Visiting team entrance followed by introductions of its starters
12:58:30 PM	8:30	Home team entrance followed by introduction of its starters
1:03 PM	4:00	Officials, captains proceed to midfield for ceremonial coin toss
1:04 PM	3:00	Official coin toss conducted at mid-field
1:05:30 PM	1:30	Teams take position on field for kickoff
1:06 PM	0:01	Reset game clock to 12:00. Referee signals ready for play.
1:07 PM	0:00	KICKOFF
2:00 PM	2:15	Half-time
3:15 PM	7:00	Ceremony volunteers to field with all awards and podiums. PA coordination volunteer to PA booth
3:18 PM	6:00	Principal or school representative must join their respective team on the sideline
3:25 PM	2:00	School representative from each school will make a public announcement informing the crowd to stay off the field of play and warn of the consequences. The 2 minute warning will be during the first clock stoppage after 2:30 is left on the clock
3:30 PM		Approximate GAME END time. Clock operator places 10:00 on clock for post game celebration and on-field interviews
3:40 PM		Approximate post game ceremony start time. On field interviews end
4:00 PM		Clear stadium. Stadium and field volunteers take breaks as crowd permits
4:45 PM		Locker Rooms cleared of 3A teams
5:00 PM		Locker rooms open for teams for 4A championship game
6:00 PM		Stands clear of 3A spectators. Gates open for 4A game



**Saturday, December 5, 2015**  
**Class 4A Game Schedule**

Real Time	Game Clock	Activity
4:00 PM		Approximate. Clear stadium. Stadium and field volunteers take breaks as crowd permits
5:00PM		Locker Rooms available to teams for 4A championship
5:30 PM		Ticket takers, on-field security, and ushers back in place
		Playing surface open to competing teams
6:00 PM		Citrus Bowl Opens
		Gates open for 4A game
6:15 PM		All officials in place
		PA announcer and game statisticians in place
6:37 PM	30:00	Clock Operator starts 30 minute countdown on clock and pre-game warm up ends
6:39 PM	28:00	Scholar Athlete Award Presentation at mid-field
6:47 PM	20:00	Announcer begins pre-game script
6:48:30 PM	18:30	Presentation of colors on field
6:50 PM	17:00	Pledge of Allegiance
6:51 PM	16:00	National Anthem is performed
6:52 PM	15:00	Teams report to tunnel to line up for introductions (visitor first)
6:54 PM	13:00	Visiting team entrance followed by introductions of its starters
6:58:30 PM	8:30	Home team entrance followed by introduction of its starters
7:03 PM	4:00	Officials, captains proceed to midfield for ceremonial coin toss
7:04 PM	3:00	Official coin toss conducted at mid-field
7:05:30 PM	1:30	Teams take position on field for kickoff
7:06 PM	0:00	Reset game clock to 12:00. Referee signals ready for play.
7:07 PM	0:01	KICKOFF
8:00 PM	2:15	Half-time
9:00 PM		End ticket sales. Close booth operations
9:15 PM	7:00	Ceremony volunteers to field with all awards and podiums. PA coordination volunteer to PA booth
9:18 PM	6:00	Principal or school representative must join their respective team on the sideline
9:25 PM	2:00	School representative for each school to make a public announcement informing the crowd to stay off the field and warn of the consequences. The 2 minute warning will be during the first play stoppage inside of 2:30 minutes left on the clock
9:30 PM		Approx. Game End time. Clock operator places 10:00 minutes on the game clock for post game celebration and on-field interviews
9:40 PM		Post game ceremony start time. On-field interviews end
10:00 PM		Clear stadium. Stadium and field volunteers
		Stadium clean up begins
10:30 PM		Close Press box
		Close Varsity Club
10:45 PM		Stands clear of 4A spectators
11:00 PM		Dressing rooms clear of 4A competitors

**Friday, December 11, 2015**  
**Class 5A Game Schedule**

Real Time	Game Clock	Activity
10:00 AM		Volunteers begin check in at the Varsity Club
10:30 AM		Will call and one ticket sales window sets up
		Official Dressing and meeting rooms open
		Hospitality volunteers arrive and set up hospitality
11:00 AM		Security sweep of building
		Parking attendants in place
		Ticket takers, on-field security, and ushers arrive
		Dressing facilities available to competing teams
11:15 AM		Ticket takers, on-field security, and ushers in place
11:30 AM		Ticket windows open
		Field available to teams
12:00 PM		Citrus Bowl Opens
		Hospitality room opens
12:15 PM		All officials in place
		PA announcer and game statistician in place
12:37 PM	30:00	Clock Operator starts 30 minute countdown on clock and pre-game warm up ends
12:39 PM	28:00	Scholar Athlete Award Presentation at mid-field
12:47 PM	20:00	Announcer begins pre-game script
12:48:30 PM	18:30	Presentation of colors on field
12:50 PM	17:00	Pledge of Allegiance
12:51 PM	16:00	National Anthem is performed
12:52 PM	15:00	Teams report to tunnel to line up for introductions (visitor first)
12:54 PM	13:00	Visiting team entrance followed by introductions of its starters
12:58:30 PM	8:30	Home team entrance followed by introduction of its starters
1:03 PM	4:00	Officials, captains proceed to midfield for ceremonial coin toss
1:04 PM	3:00	Official coin toss conducted at mid-field
1:05:30 PM	1:30	Teams take position on field for kickoff
1:06 PM	0:01	Reset game clock to 12:00. Referee signals ready for play.
1:07 PM	0:00	KICKOFF
2:00 PM	2:15	Half-time
3:15 PM	7:00	Ceremony volunteers to field with all awards and podiums. PA coordination volunteer to PA booth
3:18 PM	6:00	Principal or school representative must join their respective team on the sideline
3:25 PM	2:00	School representative from each school will make a public announcement informing the crowd to stay off the field of play and warn of the consequences. The 2 minute warning will be during the first clock stoppage after 2:30 is left on the clock
3:30 PM		Approximate GAME END time. Clock operator places 10:00 on clock for post game celebration and on-field interviews
3:40 PM		Approximate post game ceremony start time. On field interviews end
4:00 PM		Clear stadium. Stadium and field volunteers take breaks as crowd permits
4:45 PM		Locker Rooms cleared of 5A teams
5:00 PM		Locker rooms open for teams for 7A championship game
6:00 PM		Stands clear of 5A spectators. Gates open for 7A game

**Friday, December 11, 2015**  
**Class 7A Game Schedule**

Real Time	Game Clock	Activity
4:00 PM		Approximate. Clear stadium. Stadium and field volunteers take breaks as crowd permits
5:00PM		Locker Rooms available to teams for 7A championship
5:30 PM		Ticket takers, on-field security, and ushers back in place
		Playing surface open to competing teams
6:00 PM		Citrus Bowl Opens
		Gates open for 7A game
6:15 PM		All officials in place
		PA announcer and game statisticians in place
6:37 PM	30:00	Clock Operator starts 30 minute countdown on clock and pre-game warm up ends
6:39 PM	28:00	Scholar Athlete Award Presentation at mid-field
6:47 PM	20:00	Announcer begins pre-game script
6:48:30 PM	18:30	Presentation of colors on field
6:50 PM	17:00	Pledge of Allegiance
6:49 PM	16:00	National Anthem is performed
6:48 PM	15:00	Teams report to tunnel to line up for introductions (visitor first)
6:50 PM	13:00	Visiting team entrance followed by introductions of its starters
6:58:30 PM	8:30	Home team entrance followed by introduction of its starters
7:03 PM	4:00	Officials, captains proceed to midfield for ceremonial coin toss
7:04 PM	3:00	Official coin toss conducted at mid-field
7:05:30 PM	1:30	Teams take position on field for kickoff
7:06 PM	0:01	Reset game clock to 12:00. Referee signals ready for play.
7:07 PM	0:00	KICKOFF
8:00 PM	2:15	Half-time
9:00 PM		End ticket sales. Close booth operations
9:15 PM	7:00	Ceremony volunteers to field with all awards and podiums. PA coordination volunteer to PA booth
9:18 PM	6:00	Principal or school representative must join their respective team on the sideline
9:25 PM	2:00	School representative for each school to make a public announcement informing the crowd to stay off the field and warn of the consequences. The 2 minute warning will be during the first play stoppage inside of 2:30 minutes left on the clock
9:30 PM		Approx. Game End time. Clock operator places 10:00 minutes on the game clock for post game celebration and on-field interviews
9:40 PM		Post game ceremony start time. On-field interviews end
10:00 PM		Clear stadium. Stadium and field volunteers
		Stadium clean up begins
10:30 PM		Close Press box
		Close Varsity Club
10:45 PM		Stands clear of 7A spectators
11:00 PM		Dressing rooms clear of 7A competitors

**Saturday, December 12, 2015**  
**Class 6A Game Schedule**

Real Time	Game Clock	Activity
10:00 AM		Volunteers begin check in at the Varsity Club
10:30 AM		Will call and one ticket sales window sets up
		Official Dressing and meeting rooms open
		Hospitality volunteers arrive and set up hospitality
11:00 AM		Security sweep of building
		Parking attendants in place
		Ticket takers, on-field security, and ushers arrive
		Dressing facilities available to competing teams
11:15 AM		Ticket takers, on-field security, and ushers in place
11:30 AM		Ticket windows open
		Field available to teams
12:00 PM		Citrus Bowl Opens
		Hospitality room opens
12:15 PM		All officials in place
		PA announcer and game statistician in place
12:37 PM	30:00	Clock Operator starts 30 minute countdown on clock and pre-game warm up ends
12:39 PM	28:00	Scholar Athlete Award Presentation at mid-field
12:47 PM	20:00	Announcer begins pre-game script
12:48:30 PM	18:30	Presentation of colors on field
12:50 PM	17:00	Pledge of Allegiance
12:51 PM	16:00	National Anthem is performed
12:52 PM	15:00	Teams report to tunnel to line up for introductions (visitor first)
12:54 PM	13:00	Visiting team entrance followed by introductions of its starters
12:58:30 PM	8:30	Home team entrance followed by introduction of its starters
1:03 PM	4:00	Officials, captains proceed to midfield for ceremonial coin toss
1:04 PM	3:00	Official coin toss conducted at mid-field
1:05:30 PM	1:30	Teams take position on field for kickoff
1:06 PM	0:01	Reset game clock to 12:00. Referee signals ready for play.
1:07 PM	0:00	KICKOFF
2:00 PM	2:15	Half-time
3:15 PM	7:00	Ceremony volunteers to field with all awards and podiums. PA coordination volunteer to PA booth
3:18 PM	6:00	Principal or school representative must join their respective team on the sideline
3:25 PM	2:00	School representative from each school will make a public announcement informing the crowd to stay off the field of play and warn of the consequences. The 2 minute warning will be during the first clock stoppage after 2:30 is left on the clock
3:30 PM		Approximate GAME END time. Clock operator places 10:00 on clock for post game celebration and on-field interviews
3:40 PM		Approximate post game ceremony start time. On field interviews end
4:00 PM		Clear stadium. Stadium and field volunteers take breaks as crowd permits
4:45 PM		Locker Rooms cleared of 6A teams
5:00 PM		Locker rooms open for teams for 8A championship game
6:00 PM		Stands clear of 6A spectators. Gates open for 8A game

**Saturday, December 12, 2015**  
**Class 8A Game Schedule**

Real Time	Game Clock	Activity
4:00 PM		Approximate. Clear stadium. Stadium and field volunteers take breaks as crowd permits
5:00PM		Locker Rooms available to teams for 8A championship
5:30 PM		Ticket takers, on-field security, and ushers back in place
		Kickers permitted on playing surface
6:00 PM		Citrus Bowl Opens
		Gates open for 8A game
		Playing surface open to competing teams
6:15 PM		All officials in place
		PA announcer and game statisticians in place
6:37 PM	30:00	Clock Operator starts 30 minute countdown on clock and pre-game warm up ends
6:39 PM	28:00	Scholar Athlete Award Presentation at mid-field
6:47 PM	20:00	Announcer begins pre-game script
6:48:30 PM	18:30	Presentation of colors on field
6:50 PM	17:00	Pledge of Allegiance
6:51 PM	16:00	National Anthem is performed
6:52 PM	15:00	Teams report to tunnel to line up for introductions (visitor first)
6:54 PM	13:00	Visiting team entrance followed by introductions of its starters
6:58:30 PM	8:30	Home team entrance followed by introduction of its starters
7:03 PM	4:00	Officials, captains proceed to midfield for ceremonial coin toss
7:04 PM	3:00	Official coin toss conducted at mid-field
7:05:30 PM	1:30	Teams take position on field for kickoff
7:06 PM	0:01	Reset game clock to 12:00. Referee signals ready for play.
7:07 PM	0:00	KICKOFF
8:00 PM	2:15	Half-time
9:00 PM		End ticket sales. Close booth operations
9:15 PM	7:00	Ceremony volunteers to field with all awards and podiums. PA coordination volunteer to PA booth
9:18 PM	6:00	Principal or school representative must join their respective team on the sideline
9:25 PM	2:00	School representative for each school to make a public announcement informing the crowd to stay off the field and warn of the consequences. The 2 minute warning will be during the first play stoppage inside of 2:30 minutes left on the clock
9:30 PM		Approx. Game End time. Clock operator places 10:00 minutes on the game clock for post game celebration and on-field interviews
9:40 PM		Post game ceremony start time. On-field interviews end
10:00 PM		Clear stadium. Stadium and field volunteers
		Stadium clean up begins
10:30 PM		Close Press box
		Close Varsity Club
10:45 PM		Stands clear of 8A spectators
11:00 PM		Dressing rooms clear of 8A competitors

## X. APPENDIX

### 2015 FHSAA Football Finals

#### Information, Credentials, and Supplies Request Sheet

**Note:** This form must be FAXED to the Central Florida Sports Commission at 407-649-2072 by 4:00pm on **December 2<sup>nd</sup> and December 9<sup>th</sup>**. **All credentials must be picked up by the person(s) indicated below, two hours before kick-off.** These may be picked up in the Varsity Club located between Gate C and D, in the main office building on the 1<sup>st</sup> floor. Pick up of credentials may be made **only** by the person indicated below, for the categories of: football team, cheerleader, and school administration. Band credentials will be delivered by the LOC Band Coordinator to each band director upon their arrival. Based upon past experience, we suggest that different people be designated to pick up credentials, as each group will likely be arriving at different times. Credentials will be prepared for only those people listed below. A detailed Participant Manual has been sent to your school athletic director. It is also available for viewing on-line at [fhsaa.org](http://fhsaa.org). If you have any questions, contact our office at 407-648-4900.

#### GENERAL INFORMATION

School Name: \_\_\_\_\_ Team Nickname: \_\_\_\_\_

Principal: \_\_\_\_\_ Cell Phone: \_\_\_\_\_

Athletic Director: \_\_\_\_\_ Cell Phone: \_\_\_\_\_

Football Coach: \_\_\_\_\_ Cell Phone: \_\_\_\_\_

Band Director: \_\_\_\_\_ Cell Phone: \_\_\_\_\_

Business Manager: \_\_\_\_\_ Office Phone: \_\_\_\_\_

Classification: \_\_\_\_\_ Date of Game: \_\_\_\_\_ Time of Game: \_\_\_\_\_

Arrival Date & Time: \_\_\_\_\_ Departure Date & Time: \_\_\_\_\_

#### FOOTBALL TEAM INFORMATION

##### General Information:

Numbers of Players Dressing Out: \_\_\_\_\_

Number of Buses: \_\_\_\_\_

##### Travel Information:

Staying overnight in Orlando? \_\_\_\_\_ If yes, where are you staying? \_\_\_\_\_

Hotel Address: \_\_\_\_\_

How many rooms? \_\_\_\_\_ How many nights? \_\_\_\_\_

If you require assistance with hotel rooms, please refer to page 15 of the manual.

**Equipment and Other Needs:** Please call Megan Masias at 407-515-6550 with questions or other requests.

**PLEASE NOTE, TAPE AND TOWELS WILL NOT BE PROVIDED. TEAMS MUST SUPPLY THEIR OWN TAPE AND TOWELS.**

Access to Film Deck? \_\_\_\_\_ No \_\_\_\_\_ Yes

Access to Coaches' Box? \_\_\_\_\_ No \_\_\_\_\_ Yes

Will You Be Bringing Cool Zone Units? \_\_\_\_\_ No \_\_\_\_\_ Yes If Yes, How Many? \_\_\_\_\_ Will You Need Power? \_\_\_\_\_

Other Requests? \_\_\_\_\_

\*Teams must supply their own headsets for use during games.

**FOOTBALL TEAM INFORMATION CONTINUED****Credential Information:**

Person authorized to pick up credentials for the team, medical, law enforcement and team administration: \_\_\_\_\_

**Sideline Credentials:** Twenty-four credentials for use by coaches, managers, and student-athletes not in uniform. This will grant access to the team bench, sideline and coaching booth. Please note, only 8 individuals are allowed in the coaching booth at one time.

- |           |           |
|-----------|-----------|
| 1. _____  | 13. _____ |
| 2. _____  | 14. _____ |
| 3. _____  | 15. _____ |
| 4. _____  | 16. _____ |
| 5. _____  | 17. _____ |
| 6. _____  | 18. _____ |
| 7. _____  | 19. _____ |
| 8. _____  | 20. _____ |
| 9. _____  | 21. _____ |
| 10. _____ | 22. _____ |
| 11. _____ | 23. _____ |
| 12. _____ | 24. _____ |

**Videographer:** Two credentials for us by the school's official team videographers. This will grant access to the team video room located on the press box and field access in areas designated by the LOC. Any on-field videography must take place from behind the yellow line field marking, except during the post-game interview period.

- |          |          |
|----------|----------|
| 1. _____ | 2. _____ |
|----------|----------|

**Coaches Spouses/Guests:** Six general admission tickets for use of the coaches' spouses and/or guests. This will grant complimentary general admission to their championship game. This will not grant field access. **The LOC will hold these allotted tickets for coaches; however, the coach must provide the name of each person picking up their individual ticket. The ID of each individual will be checked when they sign the appropriate log at the East Breezeway, located between Gate C and Gate D.**

- |          |          |
|----------|----------|
| 1. _____ | 4. _____ |
| 2. _____ | 5. _____ |
| 3. _____ | 6. _____ |

**MEDICAL INFORMATION****General Information:**

One certified athletic trainer will be available to assist each team 90 minutes prior to kick-off and will remain on the sideline. A doctor and EMT's will also be available. If you have your own team doctor and athletic trainer, please fill in their names below to receive medical credentials. **PLEASE NOTE, TEAMS MUST BRING OWN ATHLETIC SUPPLIES (i.e. tape, pre-wrap, etc.). SUPPLIES WILL NOT BE PROVIDED.**

**Credential Information:**

**Team Doctor:** One credential for use of team doctor. This will grant access to the team bench and sideline.

Name: \_\_\_\_\_ Cell Phone # \_\_\_\_\_

**Team Athletic Trainer:** One credential for use of team athletic trainer. This will grant access to the team bench and sideline.

Name: \_\_\_\_\_ Florida Athletic Trainer License # \_\_\_\_\_

**LAW ENFORCEMENT INFORMATION****General Information:**

You will be permitted three law enforcement escorts—in uniform—on the sidelines. If you require more than three uniformed officers, please contact the LOC for permission. Permission will be granted provided all escorting officers work with the City of Orlando Police Department officers for crowd control. Please note, City of Orlando Police Department has full jurisdiction in and around Orlando Citrus Bowl.

**Law Enforcement Escorts:**

1. \_\_\_\_\_ 3. \_\_\_\_\_  
2. \_\_\_\_\_

**TEAM ADMINISTRATION INFORMATION****Reserved Parking Information:**

The LOC is providing each school (5) reserved parking spaces in parking lot G. Please print the name of each school administrator for whom you are requesting a reserved parking spot. Each administrator must show proper identification (ex. Driver's license) to access parking lot G.

1. \_\_\_\_\_ 4. \_\_\_\_\_  
2. \_\_\_\_\_ 5. \_\_\_\_\_  
3. \_\_\_\_\_

**Credential Information:**

**Team Administration:** Six credentials for use by principal, assistant principal, athletic director, etc. This will grant temporary access to the sideline (Pre, half and post game only) and access to the FHSAA Hospitality Suite.

1. \_\_\_\_\_ 4. \_\_\_\_\_  
2. \_\_\_\_\_ 5. \_\_\_\_\_  
3. \_\_\_\_\_ 6. \_\_\_\_\_

**CHEERLEADER INFORMATION****General Information:**

Cheerleaders in uniform and one mascot in uniform will be admitted without charge for the game in which their school's team directly participates. Only two credentials for coaches and chaperones will be offered to each cheerleading squad. **HALFTIME PERFORMANCES WILL BE LIMITED TO 7 MINUTES PER TEAM. PLEASE COORDINATE PERFORMANCE SCHEDULE BETWEEN BAND AND CHEERLEADERS.**

Will the cheerleaders be arriving together or separate? \_\_\_\_\_ If arriving together, will you be arriving on your own bus, band bus or football bus? \_\_\_\_\_

Will you perform at halftime? \_\_\_\_\_ Will you be bringing a mascot? \_\_\_\_\_ If yes, please include name: \_\_\_\_\_

**Credential Information:**

Person authorized to pick up credentials: \_\_\_\_\_

**Coaches/Chaperones:** Two credentials will be offered to each cheerleading squad for coaches or chaperones. Credential will grant access to sideline.

1. \_\_\_\_\_ 2. \_\_\_\_\_



**BAND AND DRILL INFORMATION****General Information:**

Band and drill team members, in uniform and performing, will be permitted free admission in accordance to FHSAA Rules. One adult chaperone per ten (10) participating students will also be admitted free of charge. The Band Director will not be counted as a chaperone and will get own separate credential. Please call the, Band Coordinator for assistance: 407-648-4900 ext. 110.

**HALFTIME PERFORMANCES WILL BE LIMITED TO 7 MINUTES PER TEAM. PLEASE COORDINATE PERFORMANCE SCHEDULE BETWEEN BAND AND CHEERLEADERS.**

Number of band members attending: \_\_\_\_\_

Number of busses to be used: \_\_\_\_\_

Do you have an equipment truck? \_\_\_\_\_

Will you perform at halftime? \_\_\_\_\_

Do you have a half time announcer? \_\_\_\_\_

**Credential Information:**

Person authorized to pick up credentials: \_\_\_\_\_

**Band Director:** One credential for use of the band director. This will grant temporary access to the sideline (Pre and Halftime) and access to the press box.

Name: \_\_\_\_\_

**Chaperones:** One chaperone per 10 band members participating will be granted a credential. Credential will grant temporary access to sideline (Pre and Halftime).

How many chaperones? \_\_\_\_\_

**SCHOOL ADMINISTRATION INFORMATION****Credentials:**

Two credentials for use by school administrator who will be in attendance and will assume responsibility for their school and their school representatives before, during and after the game. This will grant access to the sideline and access to the FHSAA Hospitality Suite. **PLEASE NOTE, CREDENTIALS WILL ONLY BE ISSUED PERSONALLY TO THIS ADMINISTRATOR UPON THEIR ARRIVAL AND CHECK IN AT THE VARSITY CLUB.**

School Administrator Name: \_\_\_\_\_ Title: \_\_\_\_\_

School Administrator Signature: \_\_\_\_\_ Cell Phone #: \_\_\_\_\_

School Administrator Guest: \_\_\_\_\_



2015 FHSAA Football Finals  
Awards Presentation Lineup Sheet (pg. 1 of 2)

**Complete and turn in to LOC member at credential pick up or team  
credentials will not be distributed.**

*Type or print legibly.*

School: \_\_\_\_\_

Presenter(s) [names and title]: \_\_\_\_\_

Trophy will be accepted by head coach and [check one]: ( \_\_\_\_\_ Captains) ( \_\_\_\_\_ Seniors)

List head coach (HC) first, followed by assistant coaches (AC) and then players in numerical order. Do not list managers, statisticians, trainers, team doctors, etc. Their names will not be called. Do not list more than 80 names. The 81<sup>st</sup> name and thereafter will not be announced.

No. or Title	Name	No. or Title	Name
1. _____	_____	22. _____	_____
2. _____	_____	23. _____	_____
3. _____	_____	24. _____	_____
4. _____	_____	25. _____	_____
5. _____	_____	26. _____	_____
6. _____	_____	27. _____	_____
7. _____	_____	28. _____	_____
8. _____	_____	29. _____	_____
9. _____	_____	30. _____	_____
10. _____	_____	31. _____	_____
11. _____	_____	32. _____	_____
12. _____	_____	33. _____	_____
13. _____	_____	34. _____	_____
14. _____	_____	35. _____	_____
15. _____	_____	36. _____	_____
16. _____	_____	37. _____	_____
17. _____	_____	38. _____	_____
18. _____	_____	39. _____	_____
19. _____	_____	40. _____	_____
20. _____	_____	41. _____	_____
21. _____	_____	42. _____	_____



2015 FHSAA Football Finals  
Awards Presentation Lineup Sheet (pg. 1 of 2)

**Complete and turn in to LOC member at credential pick up or team  
credentials will not be distributed.**

*Type or print legibly.*

School: \_\_\_\_\_

No. or Title	Name	No. or Title	Name
43. _____	_____	62. _____	_____
44. _____	_____	63. _____	_____
45. _____	_____	64. _____	_____
46. _____	_____	65. _____	_____
47. _____	_____	66. _____	_____
48. _____	_____	67. _____	_____
49. _____	_____	68. _____	_____
50. _____	_____	69. _____	_____
51. _____	_____	70. _____	_____
52. _____	_____	71. _____	_____
53. _____	_____	72. _____	_____
54. _____	_____	73. _____	_____
55. _____	_____	74. _____	_____
56. _____	_____	75. _____	_____
57. _____	_____	76. _____	_____
58. _____	_____	77. _____	_____
59. _____	_____	78. _____	_____
60. _____	_____	79. _____	_____
61. _____	_____	80. _____	_____

DO NOT LIST MORE THAN 80 NAMES.  
THE 81<sup>ST</sup> NAME AND THEREAFTER WILL NOT BE ANNOUNCED.

COMPLETE AND TURN IN TO LOC MEMBER AT CREDENTIAL PICK UP OR  
CREDENTIALS WILL NOT BE DISTRIBUTED.



## 2015 FHSAA Football Finals Game Viewing Form

Complete and fax back to Megan Masias at (407) 649-2072 no later than **4:00 P.M. on December 2, 2015 and December 9, 2015**. Preference for complimentary admission will be given to teams competing in a championship game prior to or immediately after the game they wish to view. To obtain admission, the team must check in at the East Breezeway, located between Gate C and Gate D. All players must be wearing their team jersey or warm ups.

**School Name:** \_\_\_\_\_

**Game(s) you wish to attend:** \_\_\_\_\_

**Personnel** (Only 20 personnel will be admitted for free):

_____	_____
_____	_____
_____	_____
_____	_____
_____	_____
_____	_____
_____	_____
_____	_____
_____	_____

**Players** (Only 60 Varsity players will be admitted for free):

_____	_____
_____	_____
_____	_____
_____	_____
_____	_____
_____	_____
_____	_____
_____	_____
_____	_____
_____	_____
_____	_____
_____	_____
_____	_____
_____	_____
_____	_____
_____	_____
_____	_____
_____	_____
_____	_____
_____	_____

<b>DIRECTIONS TO ORLANDO</b>
------------------------------

**Directions to Orlando Citrus Bowl from the North**

- Take I-4 West (toward Orlando)
- Take exit 83 on the left to merge onto South St.
- Slight left stay on W. South St.
- Turn left at S. Rio Grande Ave.
- Turn right as Citrus Bowl Pl.

**Directions to Orlando Citrus Bowl from the East**

- Take 408 West
- Take exit 9 toward US-441/Orange Blossom Tr.
- Merge onto W. Long St.
- Turn right at S. Rio Grande Ave.
- Turn left at Citrus Bowl Pl.

**Directions to Orlando Citrus Bowl from the South**

- Take I-4 East (toward Orlando)
- Take exit 79 for John Young Pkwy.
- Turn left at S. John Young Pkwy.
- Turn right at Orange Center Blvd.
- Turn left at S. Tampa Ave.
- Turn right at Citrus Bowl Pl.

**Directions to Orlando Citrus Bowl from the West**

- Take 408 East
- Take exit 8B for Tampa Ave.
- Keep left at the fork, follow signs for Tampa Ave.
- Turn left at S. Tampa Ave.
- Turn right at Citrus Bowl Pl.

Case 8:16-cv-02753-CEH-AAS Document 8-2 Filed 09/30/16 Page 39 of 42 PageID 375

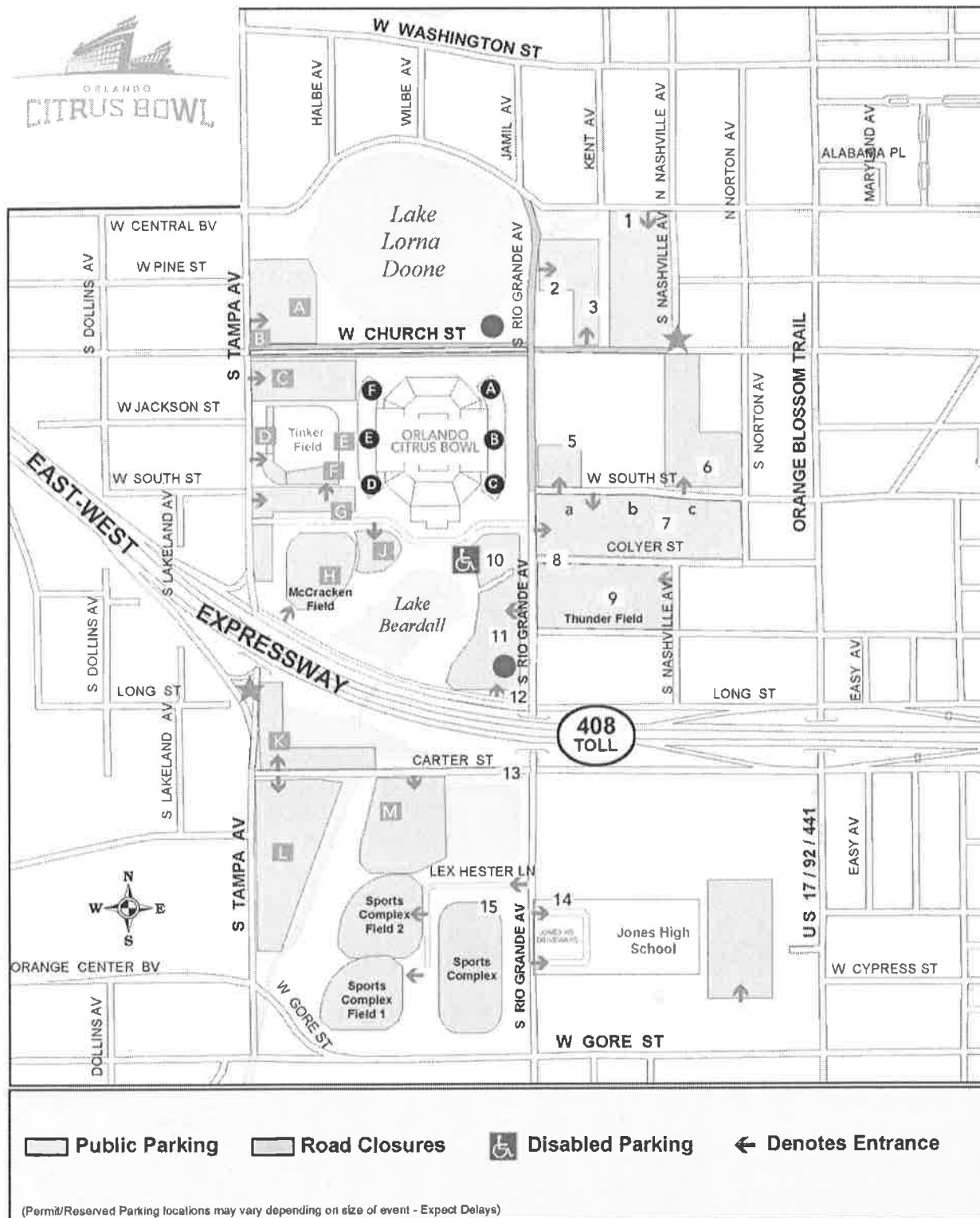

1. Box Office opens 1 ½ hours prior to kick off
2. Gate A & B—Spectator Gates
3. Church Street Closed to all vehicle traffic

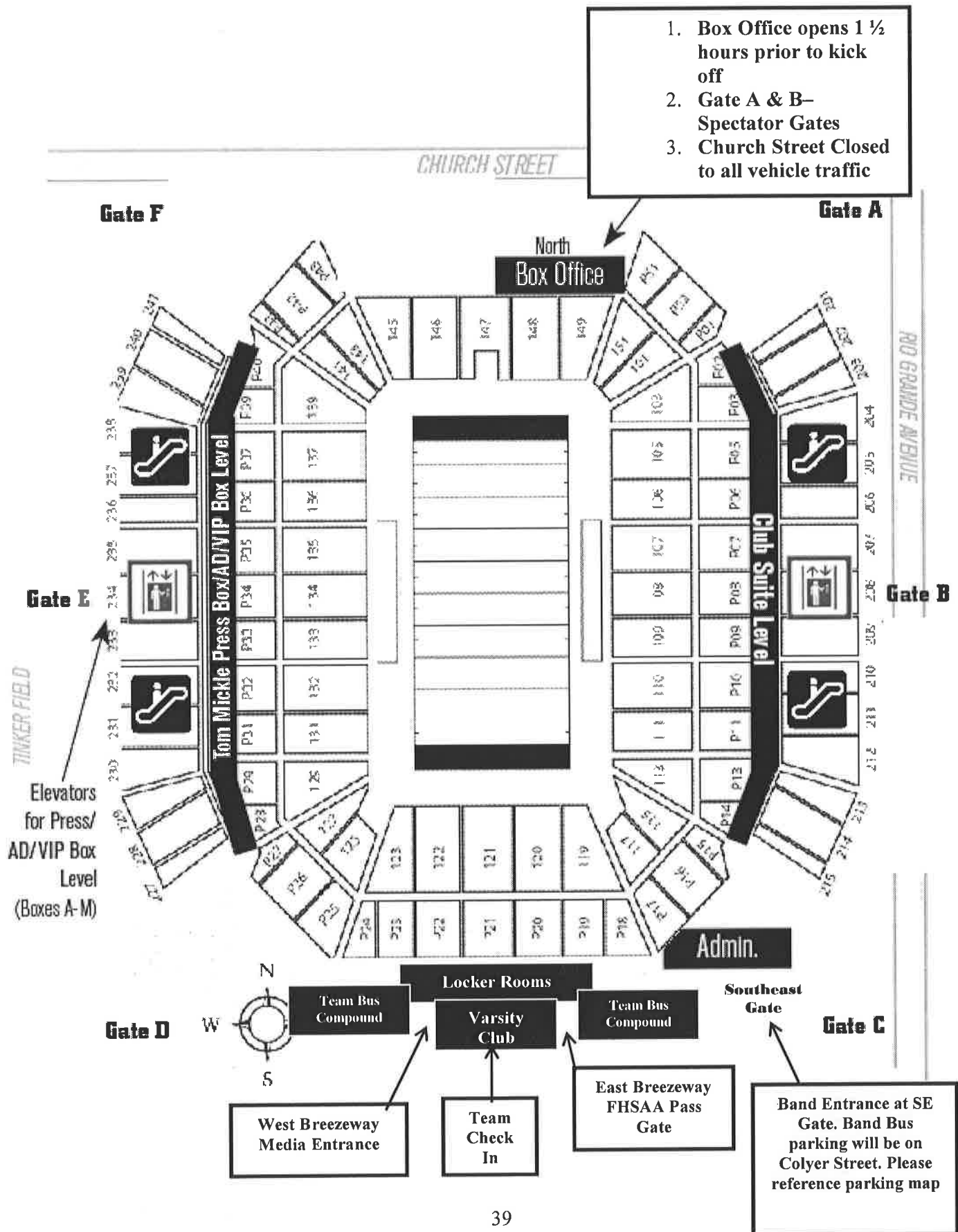



## Orlando Citrus Bowl – Press Box

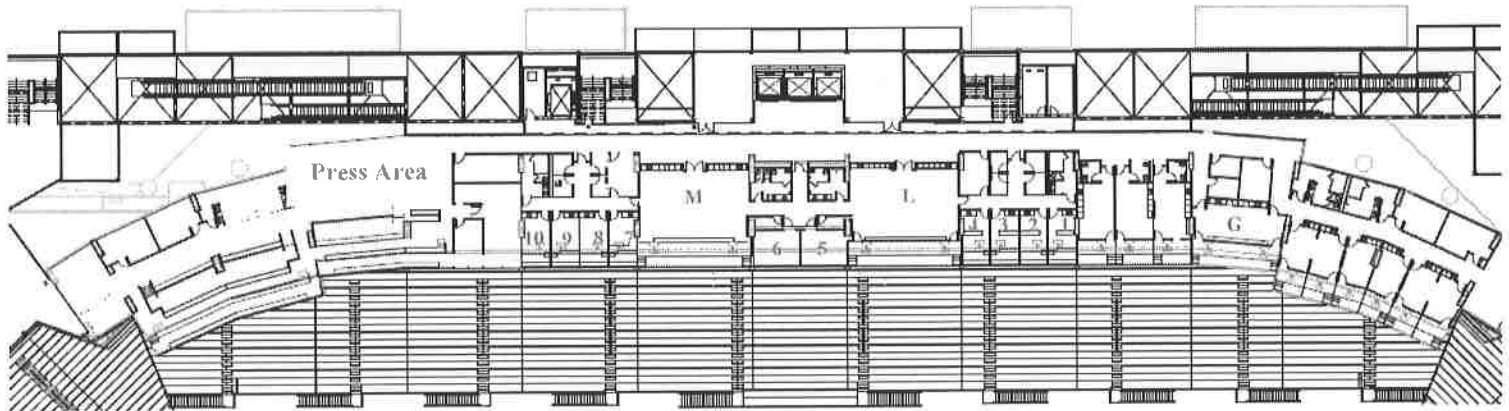

- Booth #1 – Radio 1
- Booth #2 – Radio 2
- Booth #3 – FHSAA Operations
- Booth #4 – Visiting Team Coaches
- Booth #5 – Team Videographers
- Booth #6 – Television
- Booth #7 – Home Team Coaches
- Booth #8 – FHSAA Operations
- Booth #9 – PA Announcer
- Booth #10 – Radio 3
- Suite G – LOC Hospitality
- Suite L – FHSAA Hospitality
- Suite M – Champion Hospitality

## Orlando Citrus Bowl – Backhouse Area

